

## Installation Instructions for PSG240E POWER SUPPLY

**READ INSTRUCTIONS BEFORE INSTALLING OR OPERATING THIS DEVICE. KEEP FOR FUTURE REFERENCE.**

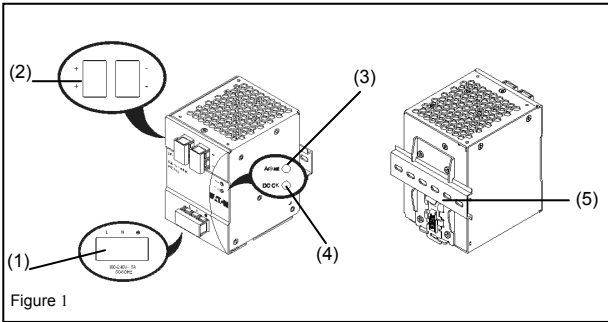

Figure 1

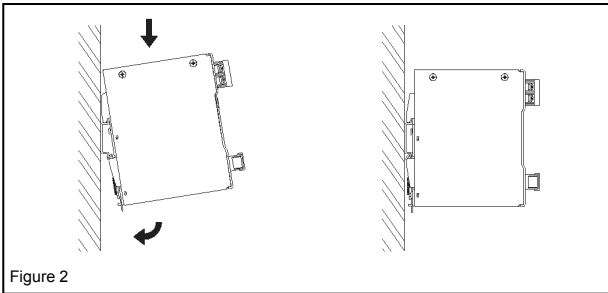

Figure 2

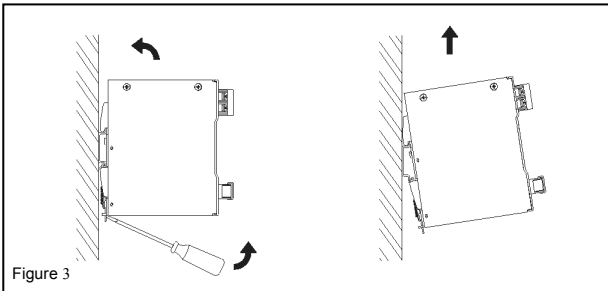

Figure 3

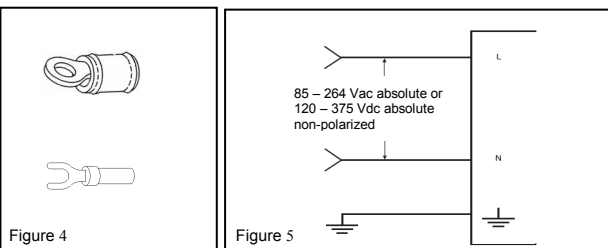

Figure 4

Figure 5

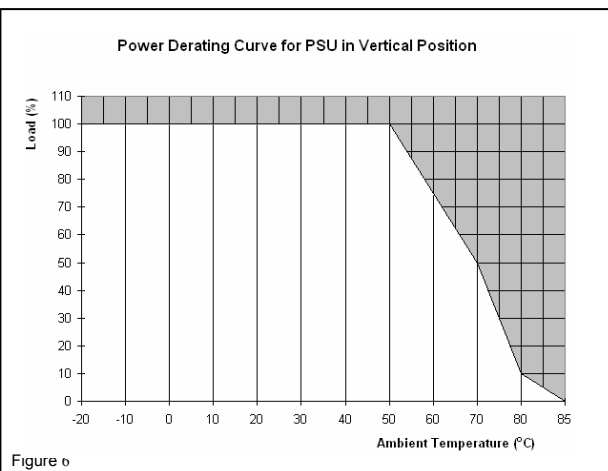

Figure 6

### 1. Safety instructions

- Switch main power off and wait 5 minutes before making any connection or disconnection on the device. Danger of explosion!
- Dangerous voltage present for at least 5 minutes after disconnecting all sources of power.
- For sufficient convection cooling keep a distance of 50 mm above and below the device as well as a lateral distance of 20 mm to other units.
- The enclosure of the device can become very hot depending on the ambient temperature and load of the power supply. Risk of burns!
- Do not introduce any objects into the unit!

### 2. Device description (Fig. 1)

- (1) Input terminal block connector
- (2) Output terminal block connector
- (3) DC voltage adjustment potentiometer
- (4) DC OK control LED (green)
- (5) Universal mounting rail system

### 3. Mounting (Fig. 2)

The power supply unit can be mounted on 35 mm DIN rails in accordance with EN 60715. The device should be installed horizontally with input terminal blocks on the bottom.

Each device is delivered ready to install.

Snap on the DIN rail as shown in Fig. 2:

1. Tilt the unit slightly upwards and put it onto the DIN rail.
2. Push downwards until stopped.
3. Press against the bottom front side for locking.
4. Shake the unit slightly to ensure that it is secured.

### 4. Removal (Fig. 3)

To uninstall, pull or slide down the latch as shown in Fig. 3. Then, slide the PSU in the opposite direction, release the latch and pull out the PSU from the rail.

### 5. Connection

The terminal block connectors allow easy and fast wiring. A plastic cover provides the necessary isolation of the electric connection.

Use flexible (stranded wire) or solid cables 0.32-2.1 mm<sup>2</sup> (AWG 22-14) and torque of 0.78-0.98 Nm (6.94-8.68 lb in). The insulation stripping length should be 7 mm

In accordance to EN 60950 / UL 60950, flexible cables require ferrules.

Use copper wire that is designed to sustain operating temperature of 75°C or more to fulfill UL requirements.

For stranded wires it is recommended to use suitable lug to crimp wires (See Fig. 4).

### 5.1. Input connection (Fig. 1 and Fig. 5)

Refer to Figure 5 for input connection.

The device has an internal fuse. 10 A or 16 A power circuit breakers are recommended as backup fuses.



The internal fuse must not be replaced by the user.  
In case of internal defect, Please call 1- 877- ETN - CARE

### 5.2. Output connection (Fig. 1 (2))

Use the "+" and "-" screw connections to establish the 24 VDC connection. The output provides 24 VDC. The output voltage can be adjusted from 22 to 28 VDC on the potentiometer. The green LED DC OK displays correct function of the output (Fig. 1 (4)).

The device has a short circuit and overload protection and an over voltage protection limited to 35 VDC.

### 5.3. Output characteristic curve

The device functions normal under operating line and load conditions. In the event of a short circuit or over load the output voltage and current collapses ( $I_{O/L}$  or  $I_{S/C}$  is  $> I_{surge}$  (150%)). The secondary voltage is reduced and bounces/oscillates until short circuit or over load on the secondary side has been removed.

### 5.4. Thermal behavior (Fig. 6)

In the case of ambient temperatures above +50°C, the output capacity has to be reduced by 2.5% per increase in temperature. If the output capacity is not reduced when  $T_{Amb} > 50^\circ\text{C}$  device will run into thermal protection by switching off i.e. device will go in bouncing/oscillates mode and will recover when ambient temperature is lowered or load is reduced as far as necessary to keep device in working condition.

**FOR TECHNICAL ASSISTANCE CALL 1 - 877- ETN – CARE**