

CAT#	A
630B	2.30
630	3.60
630DB	2.30

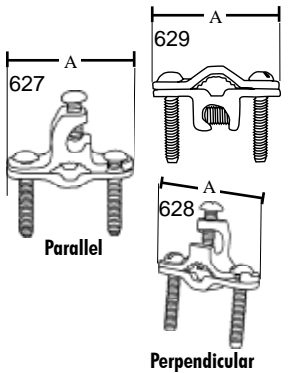

CAT#	A
625	2.36
626	2.52
627	2.28
628	2.28
629	2.28

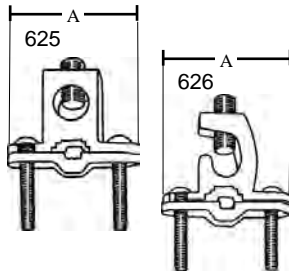
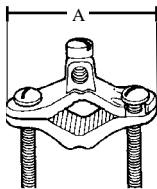

CAT#	A
620Z	2.22
620BP	2.22
626A	2.43
626BS	2.43
626B	3.60
626C	6.35
626D	8.50
620DB	2.28

## GROUND CLAMPS

• FITS 8, 6, OR 4 BARE ARMORED GROUND WIRE COPPER

BRASS					
TOPAZ CAT #	UPC#	SIZE	UNIT CTN	SHIP CASE	WT/ CASE
<b>FOR ARMORED GROUND WIRE</b>					
630B	16240	1/2" TO 1"	10	100	20
630	16250	1 1/4" TO 2"	5	50	30

**FOR DIRECT BURIAL**

BRONZE					
630DB	16260	1/2" TO 1"	10	100	20

## GROUND CLAMPS

**FOR DIRECT BURIAL STAINLESS STEEL SCREWS**

• FITS 8 STR TO 4/0 STR AWG COPPER

BRONZE					
TOPAZ CAT #	UPC#	SIZE	UNIT CTN	SHIP CASE	WT/ CASE
625	81968	1/2" TO 1"	10	100	30
626	81969	1/2" TO 1"	10	100	30
629	85209	1/2" TO 1"	10	100	21

3/8 To 1" Rebar 1/2" To 1" Water Pipe, Copperwater Pipe and Ground Rod

**FOR DIRECT BURIAL BRASS SCREWS**

• FITS 10 SOL TO 2 STR AWG COPPER

BRASS					
TOPAZ CAT #	UPC#	SIZE	UNIT CTN	SHIP CASE	WT/ CASE
627	83694	1/2" TO 1"	10	100	23
628	85208	1/2" TO 1"	10	100	23

3/8 To 1" Rebar 1/2" To 1" Water Pipe, Copperwater Pipe and Ground Rod

## GROUND CLAMPS

• FITS NO. 10, 8, 6, 4, & 2 AWG COPPER

ZINC DIE CAST					
TOPAZ CAT #	UPC#	SIZE	UNIT CTN	SHIP CASE	WT/ CASE
<b>FOR BARE WIRE</b>					
620Z*	16100	1/2" TO 1"	25	250	43
620BP**	16110	1/2" TO 1"	25	250	43
<b>BRASS PLATED</b>					

\*For Copper and Aluminum Wire

\*\*Non UL

BRASS					
TOPAZ CAT #	UPC#	SIZE	UNIT CTN	SHIP CASE	WT/ CASE
626A	16050	1/2" TO 1"	10	100	19
626BS	16060	1/2" TO 1"	10	100	20

**W/BRASS SCREWS**

626B	16070	1 1/4" TO 2"	5	50	19
626C	16080	2 1/2" TO 4"	—	10	10
626D	16082	5" TO 6"	—	10	15

**FOR DIRECT BURIAL**

BRONZE					
620DB	16090	1/2" TO 1"	10	100	20

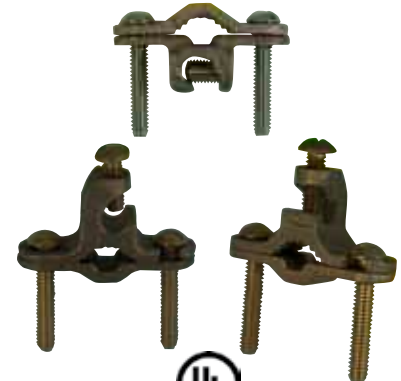
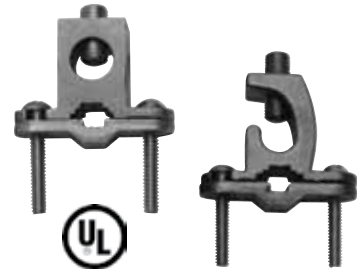

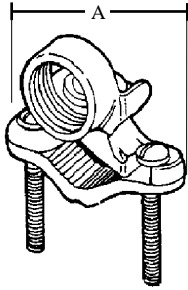

CAT#	A
621	2.250
622	3.600
623	6.340
624	8.500

621A	2.250
622A	3.600
623A	6.340
624A	8.500

621B	2.250
622B	3.600
623B	6.340
624B	8.500

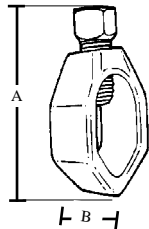

CAT#	A	B	WIRE SIZE MIN MAX
411	1.22	.75	10 SOL 2STR
412	1.41	.90	10 SOL 2STR
413	1.47	1.00	10 SOL 2STR

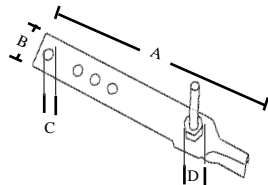

CAT#	A	B	C	D
GS1	5.810	.75	.25	1/4-20 X 1 1/4

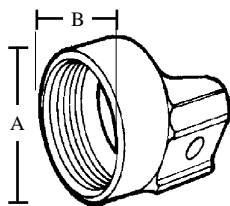

CAT#	A	B
31	1.15	1.07
32	1.30	1.28
33	1.56	1.50

## GROUND CLAMPS WITH THREADED HUBS FOR CONDUIT PIPE

BRASS

TOPAZ CAT #	UPC#	SIZE	UNIT CTN	SHIP CASE	WT/ CASE
<b>WITH 1/2" HUBS</b>					
621	16120	1/2" TO 1"	10	100	26
622	16130	1 1/4" TO 2"	5	50	35
623	16140	2 1/2" TO 4"	—	10	15
624	16150	5" TO 6"	—	10	20

### WITH 3/4" HUBS

621A	16160	1/2" TO 1"	5	50	20
622A	16170	1 1/4" TO 2"	5	50	37
623A	16180	2 1/2" TO 4"	—	10	12
624A	16190	5" TO 6"	—	10	21

### WITH 1" HUBS

621B	16200	1/2" TO 1"	—	10	9
622B	16210	1 1/4" TO 2"	—	10	10
623B	16220	2 1/2" TO 4"	—	10	21
624B	16230	5" TO 6"	—	10	28



E195122

## GROUND ROD CLAMPS FOR DIRECT BURIAL BRONZE WITH STAINLESS SCREW

BRONZE

TOPAZ CAT #	UPC#	SIZE	UNIT CTN	SHIP CASE	WT/ CASE
411	13820	1/2"	—	100	9
412	13830	5/8"	—	100	18
413	13840	3/4"	—	50	12



E195122

## GROUND STRAP

• 16 GAUGE

SOLID COPPER

TOPAZ CAT #	UPC#	SIZE	UNIT CTN	SHIP CASE	WT/ CASE
GS1	20760	1/2" TO 1"	—	100	5

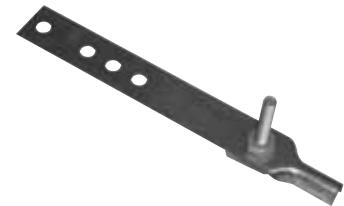

## CONDUIT HUBS

BRASS

TOPAZ CAT #	UPC#	SIZE	UNIT CTN	SHIP CASE	WT/ CASE
31	10050	1/2"	—	25	3
32	10060	3/4"	—	25	5
33	10070	1"	—	25	6



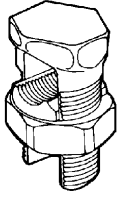

## SPLIT BOLT CONNECTORS

### SOLDERLESS

### COPPER ALLOY

CAT#	WIRE RANGE MAIN AND TAP	
	MIN.	MAX.
690	16 STR	10 STR
691	12 STR	8 STR
692	10 SOL	6 SOL
693	8 SOL	4 SOL
694	6 SOL	2 SOL
695	6 SOL	2 STR
696	4 SOL	1/0 STR
697	2 SOL	2/0 STR
698	2 SOL	3/0 STR
699	4/0 SOL	250 MCM
700	4/0 STR	350 MCM
701	250 MCM	500 MCM
702	350 MCM	750 MCM
703	500 MCM	1000 MCM

TOPAZ CAT #	UPC#	SIZE	UNIT CTN	SHIP CASE	WT/ CASE
<b>FOR COPPER AND COPPERWELD WIRE</b>					
690	17250	10	—	100	2
691	17260	8	—	100	3
692	17270	6	—	100	5
693	17280	6	—	100	6
694	17290	4	—	50	8
695	17300	2	—	50	11
696	17310	1/0	—	50	8
697	17320	2/0	—	25	7
698	17330	3/0	—	25	8
699	17340	4/0-250 MCM	—	5	10
700	17350	350 MCM	—	6	5
701	17360	500 MCM	—	6	5
702	17370	750 MCM	—	3	5
703	17380	1000 MCM	—	4	10



E155861

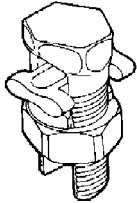

### WITH SPACER BAR

• ELECTRO-TINNED BODY, NUT, SPACER, & PRESSURE BAR

#### FOR COPPER TO COPPER (1,2)

790	18020	10	—	100	4
791	18030	8	—	100	4

#### FOR COPPER TO COPPER, COPPER TO ALUMINUM, ALUMINUM TO ALUMINUM (2)

792	18040	6	—	100	7
793	18050	4	—	100	8
794	18060	3	—	100	11
795	18070	2	—	50	15



E155861

CAT#	WIRE RANGE MAIN AND TAP	
	MIN.	MAX.
790	16 STR	10 STR
791	16 STR	8 STR
792	14 STR	6 SOL
793	10 STR	4 SOL
794	8 SOL	3 STR
795	8 SOL	2 STR
796	6 SOL	1/0 STR
797	6 STR	2/0 STR
798	4 STR	3/0 STR
799	4 STR	250 MCM
800	3/0 STR	350 MCM
801	3/0 STR	500 MCM
802	250 MCM	750 MCM
803	350 MCM	1000 MCM

#### FOR COPPER TO COPPER (1,2)

796	18080	1/0	—	50	10
797	18090	2/0	—	25	5
798	18100	3/0	—	5	15
799	18110	4/0-250 MCM	—	5	15
800	18120	350 MCM	—	12	5
801	18130	500 MCM	—	6	7
802	18140	750 MCM	—	4	7
803	18150	1000 MCM	—	2	6

(1) USABLE WITH ALUMINUM CONDUCTOR, HOWEVER NOT UL LISTED FOR THAT APPLICATION.

(2) WHEN MAKING CONNECTIONS WITH ALUMINUM OR ACSR (ALUMINUM CONDUCTOR STEEL REINFORCED) MAKE CERTAIN TO USE AN OXIDE INHIBITING COMPOUND.

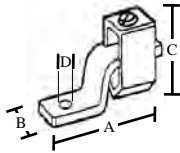

CAT#	A	B	C	D
820	1.00	.3125	.6875	.125
821	1.1875	.375	.75	.1875
822	1.3125	.50	.8125	.25
823	1.5313	.50	1.00	.25
824	1.9688	.625	1.375	.25
825	2.1875	.75	1.5625	.375
826	2.625	1.00	2.00	.3125
827	3.1875	1.00	2.625	.375
828	4.25	1.50	2.75	.375
829	4.625	2.00	3.6875	.50

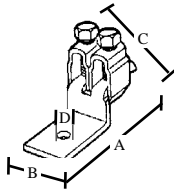

CAT#	A	B	C	D
814	3.375	1.50	2.00	.375
815	3.625	2.75	2.75	.375
816	4.4375	2.00	2.5625	.500

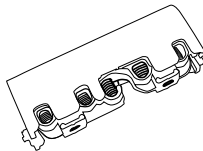

## SOLDERLESS LUGS

COPPER

TOPAZ CAT #	UPC#	AMP RATING	RECOMMENDED TORQUE IN LBS	WIRE RANGE MIN-MAX	BOLT SIZE	SHIP CASE	WT/ CASE
<b>SINGLE HOLE</b>							
• OFFSET TANG							
820	18270	25	20	14-10	1/8	250	3
821	18280	35-50	45	14-6	3/16	250	6
822	18290	70	50	14-4	1/4	200	6
823	18300	70-90	50	12-2	1/4	200	9
824	18310	125	50	8-1/0	1/4	100	11
825	18320	175	124	4-3/0	3/8	25	3
826	18330	225	204	6-4/0	5/16	25	6
827	18340	300	325	1/0-350 MCM	3/8	20	10
828	18350	400	375	4/0-500 MCM	3/8	10	7
829	18360	650	500	600MCM-1000 MCM	1/2	4	7



## DUPLEX TERMINAL LUGS

814	18240	400	-	2#1/0-2#4/0	3/8	10	5
815	18250	600	-	2#1/0-2#350 MCM	3/8	5	5
816	18260	800	-	2#4/0-2#500 MCM	1/2	4	6

## GROUNDING BRIDGE

ZINC DIE CAST

**INTERSYSTEM BONDING BRIDGE**  
Meets requirements of 2008 NEC Article 250.49

TOPAZ CAT #	UPC#	WIRE RANGE MIN-MAX	UNIT CTN	SHIP CASE	WT/ CASE
813	17544	6-2 AWG	1	10	6



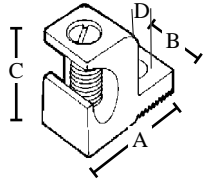

CAT#	A	B	C	D
810	1.0981	.3906	.75	.193
811	1.50	1.6099	1.4375	.25
812	2.2031	2.2031	1.7031	.3125

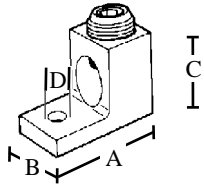

CAT#	A	B	C	D
805	1.0625	.50	.50	.25
806	1.1563	.50	.5625	.25
807	1.4088	.625	.8125	.25
808	1.4688	.625	.8125	.25
809	2.00	.9375	1.0625	.3125
1810	2.00	.8275	1.0625	.3125
817	2.25	1.125	1.25	.3125
818	2.75	1.125	1.50	.375
1818	2.75	1.375	1.50	.375
819	3.50	1.50	1.75	.50
1820	3.50	1.50	1.25	.50

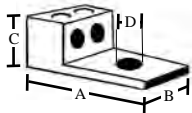

CAT#	A	B	C	D
2807	1.50	1.1875	.8125	.25
2808	1.50	1.1875	.8125	.25
2809	2.5625	1.625	1.1875	.375
2817	2.875	2.9375	1.25	.50
2818	3.125	2.375	1.5625	.50
2819	3.50	2.8125	1.6875	.625
2820	3.50	2.8125	1.6875	.625

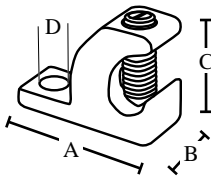

CAT#	A	B	C	D
810DB	1.1417	.38	.8464	.19

## SOLDERLESS LUGS

### LAY-IN TYPE

• TEMPERATURE RATING 90° C

Used with copper or alum. conductor **ALUMINUM**

TOPAZ CAT #	UPC#	RECOMMENDED TORQUE IN LBS	WIRE RANGE MIN-MAX	BOLT SIZE	UNIT CTN	SHIP CASE	WT/ CASE
810	18210	35	14-4	1/4	-	250	2
811	18220	50	8-1/0	1/4	-	100	6
812	18230	275	6-250 MCM	5/16	-	50	7

### SINGLE HOLE

805	18160	35	14-6	1/4	-	100	2
806	18170	50	14-2	1/4	-	100	2
807	18180	180	14-1/0	1/4	-	50	6
808	18190	120	14-2/0	1/4	-	50	5
809	18200	325	6-4/0	5/16	-	25	3
1810	18269	325	6-300 MCM	5/16	10	100	25
817	18201	325	6-350 MCM	5/16	-	25	3
818	18202	375	4-500 MCM	5/16	-	10	2
1818	18271	500	9-600 MCM	3/8	5	50	35
819	18203	500	350 MCM-800 MCM	3/8	-	5	2
1820	18272	600	500 MCM-10000 MCM	5/8	6	60	46

### DOUBLE

• TEMPERATURE RATING 90° C

2807	81830	50	14	1/0	10	100	23
2808	81831	50	14	2/0	10	100	24
2809	81832	275	6	250 MCM	10	100	26
2817	81833	275	6	350 MCM	4	40	20
2818	81834	375	2	600 MCM	4	40	19
2819	81835	375	300 MCM	800 MCM	2	20	14
2820	81836	375	500 MCM	1000 MCM	2	20	15

## SOLAR LAY IN LUG

COPPER, TINPLATED, STAINLESS STEEL SCREW

TOPAZ CAT #	UPC#	RECOMMENDED TORQUE IN LBS	WIRE RANGE MIN-MAX	BOLT SIZE	UNIT CTN	SHIP CASE	WT/ CASE
810DB	86341	35	14-4	1/4	-	100	7

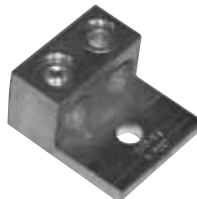
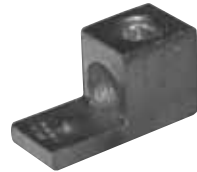

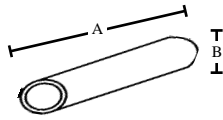

CAT#	A	B
3101	1.75	.20
3102	1.75	.20
3103	1.75	.25
3105	1.90	.31
3106	2.20	.39
3107	2.25	.44
3108	2.25	.49
3109	2.75	.55
3109A	3.25	.59
3109B	3.50	.66
3110	3.75	.70
3110A	3.75	.76
3111	4.25	.83
3111A	4.50	.93
3112	4.75	1.03

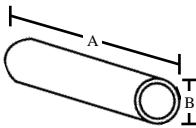

CAT#	A	B
3301	.90	.17
3302	1.00	.20
3303	1.00	.25
3305	1.25	.31
3305A	1.60	.39
3306	1.75	.44
3307	1.75	.49
3308	1.90	.55
3309	2.00	.59
3309A	2.10	.66
3310	2.10	.70
3310A	2.30	.76
3311	2.50	.83
3311A	2.50	.93
3312	3.21	1.03

## COMPRESSION SPLICES

UL LISTED PER 486A UP TO 35KV

TOPAZ CAT #	UPC#	WIRE SIZE	COLOR CODE	UNIT CTN	COPPER SHIP WT/ CASE CASE	
<b>LONG BARREL</b>						
3101	41080	8	RED	100	1000	32
3102	41081	6	BLUE	100	1000	32
3103	41082	4	GRAY	100	1000	32
3105	41084	2	BROWN	100	1000	32
3106	41085	1/0	PINK	50	1000	18
3107	41086	2/0	BLACK	50	1000	18
3108	41087	3/0	ORANGE	50	1000	18
3109	41088	4/0	PURPLE	25	250	10
3109A	41089	250 MCM	YELLOW	25	250	10
3109B	41090	300 MCM	WHITE	25	250	10
3110	41091	350 MCM	RED	25	250	12
3110A	41092	400 MCM	BLUE	25	250	12
3111	41093	500 MCM	BROWN	25	250	12
3111A	81810	600 MCM	GREEN	25	250	14
3112	81811	750 MCM	BLACK	25	250	14

TOPAZ CAT #	UPC#	WIRE SIZE	COLOR CODE	UNIT CTN	COPPER SHIP WT/ CASE CASE	
<b>SHORT BARREL</b>						
3301	81599	8	RED	100	1000	11
3302	81600	6	BLUE	100	1000	12
3303	81601	4	GRAY	100	1000	14
3305	81602	2	BROWN	100	1000	19
3305A	81603	1	GREEN	100	1000	33
3306	81604	1/0	PINK	100	1000	39
3307	81605	2/0	ORANGE	50	500	39
3308	81606	3/0	PURPLE	50	500	37
3309	81607	4/0	YELLOW	50	500	26
3309A	81608	250 MCM	WHITE	50	500	27
3310	81609	350 MCM	RED	50	500	27
3310A	81610	400 MCM	BLUE	50	500	20
3311	81611	500 MCM	BROWN	50	500	21
3311A	81612	600 MCM	GREEN	50	500	17
3312	81613	750 MCM	BLACK	20	200	22



E155861



E155861

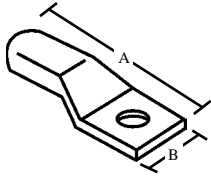

CAT#	A	B
2901	1.20	.42
2901A	1.20	.42
2902	1.50	.42
2902A	1.50	.42
2903	1.50	.71
2903A	1.50	.71
2903B	1.50	.71
2905	1.80	.83
2905A	1.83	.67
2906	1.83	.74
2907	2.24	.81
2907A	2.24	.81
2908	2.36	.90
2909	2.36	1.00
2909A	2.48	1.09
2909B	2.49	1.19
2910	2.61	1.28
2910A	3.95	1.39
2911	3.28	1.54
2911A	3.50	1.72
2912	4.37	1.90

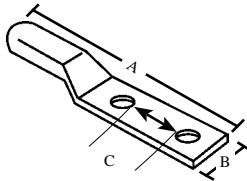

CAT#	A	B	C
2921	2.50	.45	.625
2922	2.56	.45	.625
2923	2.34	.50	.625
2925	2.58	.61	.75
2925A	3.05	.61	.75
2926	3.14	.75	.875
2927	3.24	.83	1.75
2927A	4.17	.83	1.75
2928	4.25	.91	1.75
2929	4.28	1.02	1.75
2929A	4.41	1.11	1.75
2929B	4.53	1.24	1.75
2930	4.53	1.24	1.75
2931	4.81	1.34	1.75
2932	4.88	1.52	1.75
2933	4.49	1.73	1.75
2934	4.79	1.89	1.75

## COMPRESSION LUGS

UL LISTED PER 486A UP TO 35KV

COPPER

TOPAZ CAT #	UPC#	WIRE SIZE	COLOR CODE	BOLT SIZE	UNIT CTN	SHIP CASE	WT/ CASE
-------------	------	-----------	------------	-----------	----------	-----------	----------

### ONE HOLE SHORT BARREL

2901	81614	8	RED	10	100	1000	14
2901A	81615	8	RED	1/4"	100	1000	13
2902	81616	6	BLUE	1/4"	100	1000	17
2902A	81617	6	BLUE	5/16"	100	1000	18
2903	81618	4	GRAY	1/4"	100	1000	20
2903A	81619	4	GRAY	5/16"	100	1000	18
2903B	81620	4	GRAY	3/8"	100	1000	19
2905	81621	2	BROWN	3/8"	100	1000	24
2905A	81622	1	GREEN	3/8"	100	1000	31
2906	81623	1/0	PINK	3/8"	100	1000	24
2907	81624	2/0	BLACK	3/8"	100	1000	34
2907A	81625	2/0	BLACK	1/2"	100	1000	27
2908	81626	3/0	ORANGE	3/8"	100	1000	33
2909	81627	4/0	PURPLE	1/2"	50	500	27
2909A	81804	250 MCM	YELLOW	1/2"	50	500	27
2909B	81805	300 MCM	WHITE	1/2"	50	500	27
2910	81628	350 MCM	RED	1/2"	50	500	36
2910A	81629	400 MCM	BLUE	1/2"	50	500	26
2911	81606	500 MCM	BROWN	5/8"	20	200	26
2911A	81807	600 MCM	GREEN	5/8"	20	200	26
2912	81630	750 MCM	BLACK	5/8"	20	200	26



### TWO HOLE SHORT BARREL

2921	81813	8	RED	10	100	1000	18
2922	81814	6	BLUE	1/4"	100	1000	26
2923	81815	4	GRAY	1/4"	100	1000	20
2925	81816	2	BROWN	5/16"	100	1000	18
2925A	81817	2	BROWN	3/8"	100	1000	21
2926	81818	1/0	PINK	5/16"	100	1000	21
2927	81819	2/0	BLACK	3/8"	100	1000	21
2927A	81820	2/0	BLACK	1/2"	100	1000	21
2928	81821	3/0	ORANGE	1/2"	50	500	28
2929	81822	4/0	PURPLE	1/2"	50	500	19
2929A	81803	250 MCM	YELLOW	1/2"	50	500	23
2929B	81804	300 MCM	WHITE	1/2"	50	500	26
2930	81825	350 MCM	RED	1/2"	50	500	26
2931	81826	400 MCM	BLUE	1/2"	20	200	26
2932	81807	500 MCM	BROWN	1/2"	20	200	26
2933	81808	600 MCM	GREEN	3/8"	20	200	26
2934	81839	750 MCM	BLACK	1/2"	20	200	26



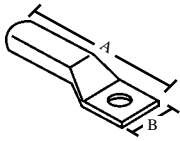

## COMPRESSION LUGS (Cont'd)

**UL LISTED PER 486A UP TO 35KV** **COPPER**

TOPAZ CAT #	UPC#	WIRE SIZE	COLOR CODE	BOLT SIZE	UNIT CTN	SHIP CASE	WT/ CASE
-------------	------	-----------	------------	-----------	----------	-----------	----------

### ONE HOLE LONG BARREL

<b>3001</b>	41050	<b>8</b>	RED	1/4"	100	1000	32
<b>3002</b>	41051	<b>6</b>	BLUE	1/4"	100	1000	32
<b>3003</b>	41052	<b>4</b>	GRAY	1/4"	100	1000	32
<b>3005</b>	41054	<b>2</b>	BROWN	3/8"	100	1000	32
<b>3005A</b>	81808	<b>1</b>	GREEN	3/8"	100	1000	32
<b>3006</b>	41055	<b>1/0</b>	PINK	3/8"	25	250	18
<b>3007</b>	41056	<b>2/0</b>	BLACK	3/8"	50	500	18
<b>3008</b>	41057	<b>3/0</b>	ORANGE	3/8"	50	500	10
<b>3008A</b>	81809	<b>3/0</b>	ORANGE	1/2"	50	500	10
<b>3009</b>	41058	<b>4/0</b>	PURPLE	1/2"	25	250	10
<b>3009A</b>	41059	<b>250 MCM</b>	YELLOW	1/2"	25	250	10
<b>3009B</b>	41061	<b>300 MCM</b>	WHITE	1/2"	25	250	10
<b>3010</b>	41062	<b>350 MCM</b>	RED	1/2"	20	200	8
<b>3010A</b>	41063	<b>400 MCM</b>	BLUE	1/2"	20	200	8
<b>3011</b>	41064	<b>500 MCM</b>	BROWN	1/2"	20	200	8
<b>3011A</b>	41065	<b>600 MCM</b>	GREEN	5/8"	20	200	8
<b>3012</b>	41066	<b>750 MCM</b>	BLACK	5/8"	20	200	8

CAT#	A	B
<b>3001</b>	1.70	.38
<b>3002</b>	1.77	.38
<b>3003</b>	1.77	.50
<b>3005</b>	2.00	.67
<b>3005A</b>	2.09	.67
<b>3006</b>	2.20	.75
<b>3007</b>	2.80	.75
<b>3008</b>	2.80	.87
<b>3008A</b>	2.80	.87
<b>3009</b>	2.80	1.00
<b>3009A</b>	3.03	1.13
<b>3009B</b>	3.39	1.13
<b>3010</b>	3.50	1.13
<b>3010A</b>	3.74	1.34
<b>3011</b>	4.02	1.50
<b>3011A</b>	4.25	1.75
<b>3012</b>	5.16	1.87



E155861

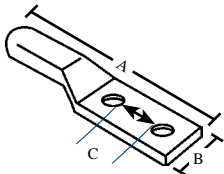

### TWO HOLE LONG BARREL

<b>3201</b>	81812	<b>8</b>	RED	1/4"	100	1000	20
<b>3202</b>	81633	<b>6</b>	BLUE	1/4"	100	1000	21
<b>3203</b>	81635	<b>4</b>	GRAY	1/4"	100	1000	21
<b>3205</b>	81636	<b>2</b>	BROWN	1/2"	100	1000	29
<b>3206</b>	81638	<b>1/0</b>	PINK	1/2"	100	1000	30
<b>3207</b>	81640	<b>2/0</b>	BLACK	1/2"	100	1000	25
<b>3208</b>	81701	<b>3/0</b>	ORANGE	1/2"	50	500	19
<b>3209</b>	81641	<b>4/0</b>	PURPLE	1/2"	50	500	19
<b>3209A</b>	81642	<b>250 MCM</b>	YELLOW	1/2"	50	500	27
<b>3209B</b>	81643	<b>300 MCM</b>	WHITE	1/2"	50	500	29
<b>3210</b>	81644	<b>350 MCM</b>	RED	1/2"	50	500	37
<b>3210A</b>	81645	<b>400 MCM</b>	BLUE	1/2"	20	200	39
<b>3211</b>	81646	<b>500 MCM</b>	BROWN	1/2"	20	200	32
<b>3211A</b>	81647	<b>600 MCM</b>	GREEN	1/2"	20	200	41
<b>3212</b>	81648	<b>750 MCM</b>	BLACK	1/2"	20	200	43

CAT#	A	B	C
<b>3201</b>	2.24	.42	.625
<b>3202</b>	2.24	.42	.625
<b>3203</b>	2.36	.49	.625
<b>3205</b>	2.87	.50	.75
<b>3206</b>	4.40	.74	.875
<b>3207</b>	4.61	.81	1.75
<b>3208</b>	4.69	.90	1.75
<b>3209</b>	4.72	1.00	1.75
<b>3209A</b>	4.95	1.09	1.75
<b>3209B</b>	5.31	1.19	1.75
<b>3210</b>	5.39	1.28	1.75
<b>3210A</b>	5.47	1.39	1.75
<b>3211</b>	5.79	1.72	1.75
<b>3211A</b>	5.79	1.72	1.75
<b>3212</b>	6.30	1.90	1.75

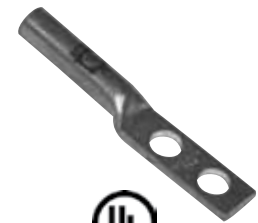

E155861





CAT#	WIRE RANGE		VOLTS
	MIN.	MAX.	
WY1	2#18	3#12	600V
WY2	2#18	3#12	600V
WR1	2#14	5#12	600V
WR2	2#14	5#12	600V
WB1	3#12	1#6 & 2#8	600V
WB2	3#12	1#6 & 2#8	600V
WG1	2#14	5#12	600V
WG2	2#14	5#12	600V
WT1	3#22	3#10	600V
WT2	3#22	3#10	600V



CAT#	WIRE RANGE		VOLTS
	MIN.	MAX.	
W81G1	2#22	2#16	300V
W82G2	2#22	2#16	300V
W82B1	2#18	3#16	300V
W82B2	2#18	3#16	300V
W83O1	2#18	2#14	600V
W83O2	2#18	2#14	600V
W84Y1	3#18	4#14&1#18	600V
W84Y2	3#18	4#14&1#18	600V
W86R1	2#14	4#12	600V
W86R2	2#14	4#12	600V

## WIRE CONNECTORS

- EASY ASSEMBLY
- COLOR CODED FOR EASY SIZE AND CAPACITY IDENTIFICATION
- TEMPERATURE RATING OF 105° C.
- SQUARE WIRE SPRING INSERT FOR SECURE CONNECTIONS

### POLYPROPYLENE

TOPAZ CAT #	UPC#	COLOR	UNIT CTN	SHIP CASE	WT/ CASE
-------------	------	-------	----------	-----------	----------

### WINGED

- JOINS #18 THRU #10 AWG

WY1	21930	YELLOW	100/BOX	5000	16
WY2	21940	YELLOW	500/BAG	5000	16

- JOINS #18 THRU #10 AWG

WR1	21950	RED	100/BOX	5000	27
WR2	21960	RED	500/BAG	5000	27

- JOINS #14 THRU #6 AWG

WB1	21970	BLUE	50/BOX	500	13
WB2	21980	BLUE	250/BAG	1000	13

- JOINS #14 THRU #10 AWG

WG1	21993	GREEN	100/BOX	5000	16
WG2	21990	GREEN	500/BAG	5000	16

- JOINS #22 THRU #8 AWG

WT1	21992	TAN	100/BOX	1000	13
WT2	21991	TAN	500/BAG	1000	35

### FLUTED BODY

- JOINS #22 THRU #14 AWG

W81G1	30520	GRAY	100/BOX	5000	4
W81G2	30530	GRAY	500/BAG	5000	4

- JOINS #22 THRU #14 AWG

W82B1	30540	BLUE	100/BOX	5000	5
W82B2	30550	BLUE	500/BAG	5000	5

- JOINS #22 THRU #14 AWG

W83O1	30560	ORANGE	100/BOX	5000	13
W83O2	30570	ORANGE	500/BAG	5000	13

- JOINS #18 THRU #10 AWG

W84Y1	30580	YELLOW	100/BOX	5000	24
W84Y2	30590	YELLOW	500/BAG	5000	24

- JOINS #18 THRU #8 AWG

W86R1	30600	RED	100/BOX	5000	52
W86R2	30610	RED	500/BAG	5000	52

(1) UL RATED AT 300 VOLTS.

(2) UL RATED AT 600 VOLTS, EXCEPT FIXTURES AND SIGNS-1,000 VOLTS.



E155861



E155861

## PLASTIC ELECTRICAL TAPE

• 7 MIL

PVC



TOPAZ CAT #	UPC#	SIZE	COLOR	UNIT CTN	SHIP CASE	WT/ CASE
830T	18370	3/4" X 30'	BLACK	10	500	41
860T	18380	3/4" X 60'	BLACK	10	200	21
866T	18410	3/4" X 66'	BLACK	—	100	20
866BLU	18411	3/4" X 66'	BLUE	—	100	20
866BRN	18412	3/4" X 66'	BROWN	—	100	20
866GRN	18413	3/4" X 66'	GREEN	—	100	20
866GRY	18414	3/4" X 66'	GRAY	—	100	20
866ORN	18415	3/4" X 66'	ORANGE	—	100	20
866RED	18417	3/4" X 66'	RED	—	100	20
866WHT	18418	3/4" X 66'	WHITE	—	100	20
866YEL	18419	3/4" X 66'	YELLOW	—	100	20
867T	18440	1 1/2" X 66'	BLACK	—	100	40



## TAPE

TOPAZ CAT #	UPC#	SIZE	COLOR		SHIP CASE	WT/ CASE
830BLU	18371	1/2" X 20'	BLUE	Phasing Tape	7	8
830BRN	18372	1/2" X 20'	BROWN	Phasing Tape	7	8
830GRN	18373	1/2" X 20'	GREEN	Phasing Tape	7	8
830GRY	18374	1/2" X 20'	GRAY	Phasing Tape	7	8
830ORN	18375	1/2" X 20'	ORANGE	Phasing Tape	7	8
830PUR	18376	1/2" X 20'	PURPLE	Phasing Tape	7	8
830RED	18377	1/2" X 20'	RED	Phasing Tape	7	8
830WHT	18378	1/2" X 20'	WHITE	Phasing Tape	7	8
830YEL	18379	1/2" X 20'	YELLOW	Phasing Tape	7	8
861	18381	2" X 36 YD	WHITE	Vinyl Tape	24	20
869	18421	3/4" X 60 YD	BLACK	Friction Tape	100	35
870	18420	3/4" X 22 YD	BLACK	Rubber Tape	100	20
870C	18396	2" X 22 YD	BLACK	Rubber Tape	50	25
870T	18423	2" X 55 YD	CLEAR	Film Tape	36	7
871C	18402	2" X 110 YD	CLEAR	Sealing Tape	36	14



## CAUTION TAPE

• NON-DETECTABLE

TOPAZ CAT #	UPC#	COLOR	UNIT CTN	SHIP CASE	WT/ CASE
1591	83029	3" x 300' YELLOW "CAUTION"	—	16	16
1592	83030	3" x 1000' YELLOW "CAUTION"	—	8	40
1593	83031	3" x 200' RED "CAUTION BURIED ELECTRIC LINE BELOW"	—	16	16
1594	83032	3" x 1000' RED "CAUTION BURIED ELECTRIC LINE BELOW"	—	8	40
1595	83033	6" x 1000' RED "CAUTION BURIED ELECTRIC LINE BELOW"	—	4	60

• DETECTABLE

1596	83034	2" x 1000' RED "CAUTION BURIED ELECTRIC LINE BELOW"	—	12	60
1597	83035	3" x 1000' RED "CAUTION BURIED ELECTRIC LINE BELOW"	—	8	64
1598	83036	6" x 1000' RED "CAUTION BURIED ELECTRIC LINE BELOW"	—	4	64



CAT#	MIL	
1591	4	Non-Detectable
1592	4	Non-Detectable
1593	4	Non-Detectable
1594	4	Non-Detectable
1595	4	Non-Detectable
1596	5	Detectable
1597	5	Detectable
1598	5	Detectable



## HEAVY DUTY CABLE LUBRICANT

TOPAZ CAT #	UPC#	SIZE	UNIT CTN	SHIP CASE	WT/ CASE
1200	19762	1 QUART	—	10	13
1201	19763	1 GALLON	—	4	25
1202	19764	5 GALLON PAIL	—	1	30

Water-based gel, Non-toxicity - Non-flammable. Compatible with all cables. Complete cleanup with water.

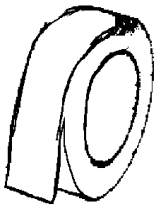

## DUCT TAPE

TOPAZ CAT #	UPC#	SIZE	UNIT CTN	SHIP CASE	WT/ CASE
868	33760	2" X 60 YARDS	—	24	42
868F	18422	2" X 50 YD FOIL TAPE	—	24	51



## ANTIOX CONTACT COMPOUND

TOPAZ CAT #	UPC#	SIZE	UNIT CTN	SHIP CASE	WT/ CASE
1209	19765	4 OUNCE BOTTLE	—	12	3
1210	19766	8 OUNCE BOTTLE	—	12	6

Prevents oxidation of Aluminum to Aluminum & Aluminum to Copper Electrical Conductors. Used for all types of connections, split-bolt and wire connectors. Non conductive

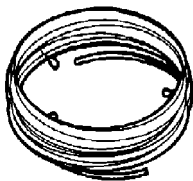

## FISH WIRE

- INDIVIDUALLY BAGGED
- REPLACEMENT FOR REWINDERS

### SPRING STEEL

TOPAZ CAT #	UPC#	SIZE	UNIT CTN	SHIP CASE	WT/ CASE
890	18980	1/8" X .060" X 25'	—	20	7
891	18990	1/8" X .060" X 50'	—	20	25
892	19000	1/8" X .060" X 100'	—	10	25
893	19010	1/8" X .060" X 200'	—	5	25
895	19020	1/4" X .060" X 50'	—	10	25
896	19030	1/4" X .060" X 100'	—	10	50
897	19040	1/4" X .060" X 200'	—	5	50



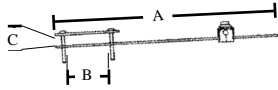

CAT#	OPENINGS			
	A	B (MIN)	B (MAX)	C (MAX)
CBS	11.00	1.00	2.25	1.25

## CEILING BOX SUPPORT

STEEL

TOPAZ CAT #	UPC#	SIZE	UNIT CTN	SHIP CASE	WT/ CASE
CBS	19891	1"- 2"	-	50	1

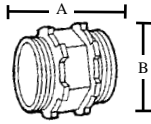

CAT#	A	B
141	1.12	.40
141A	1.12	.95

## BOX SPACING CONNECTOR WITH TWIN LOCKNUTS

ZINC DIE CAST

TOPAZ CAT #	UPC#	SIZE	UNIT CTN	SHIP CASE	WT/ CASE
141	10930	1/2"	50	500	40
141A	10932	3/4"	25	250	24



E155861

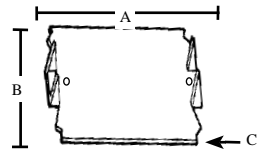

CAT#	A	B	C
187	6.00	1.50	.0598
188	5.00	1.50	.0598
189	2.50	1.50	.0598
189B	2.50	1.50	.0598
189-100	2.50	1.50	.0598

## NAIL PLATE WITH PRONGS

- 16 GAUGE
- NAIL HOLES

STEEL

TOPAZ CAT #	UPC#	SIZE	UNIT CTN	SHIP CASE	WT/ CASE
187	11497	1 1/2" X 6"	-	100	49
188	11498	1 1/2" X 5"	-	100	30
189	11500	1 1/2" X 2 1/2"	-	200	20
189B	11501	1 1/2" X 2 1/2" X 1/16"	50	200	20
189-100	11499	1 1/2" X 2 1/2" X 1/16"	-	100	20

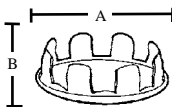

CAT#	A	B
K050	1.07	.37
K051	1.24	.31
K052	1.48	.34
K053	1.80	.31
K054	2.22	.37
K055	2.68	.36

## KNOCK-OUT SEALS

STEEL

TOPAZ CAT #	UPC#	SIZE	UNIT CTN	SHIP CASE	WT/ CASE
K050	20780	1/2"	100	1000	10
K051	20790	3/4"	100	1000	20
K052	20800	1"	50	500	9
K053	20810	1 1/4"	50	500	10
K054	20820	1 1/2"	50	500	20
K055	20830	2"	10	100	5

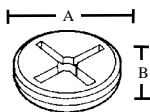

CAT#	A	B
WP50	.79	.33
WP75	1.00	.30
WP100	1.23	.28

## CLOSURE PLUGS

ZINC DIE CAST

TOPAZ CAT #	UPC#	SIZE	UNIT CTN	SHIP CASE	WT/ CASE
WP50	19700	1/2"	-	100	2
WP75	19710	3/4"	-	50	2
WP100	19720	1"	-	25	2

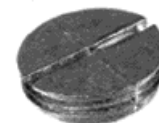

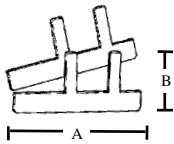

CAT#	A	B
199	5.125	2.250

## BOX SUPPORTS

TOPAZ		STEEL		
CAT #	UPC#	UNIT	SHIP	WT/
		CTN	CASE	CASE
199	11540	SOLD IN PAIRS	50 PR	500 PR 25

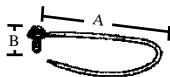

CAT#	A	B
49	7 1/2	10-32 x 3/8
50	7 1/2	10-32 x 3/8

## GREEN PIGTAIL W/SLOTTED HEX GROUND SCREW

TOPAZ		COPPER		
CAT #	UPC#	SIZE	UNIT	SHIP
			CTN	CASE
49	33505	7 1/2" 12GA. SOLID	—	100 24
50	33506	7 1/2" 14GA. SOLID	—	100 23

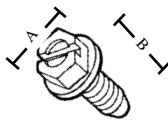

CAT#	A	B
48	.375	.625

## GREEN GROUND SCREW

TOPAZ		STEEL		
CAT #	UPC#	SIZE	UNIT	SHIP
			CTN	CASE
48	33500	10/32" X 3/8"	—	100 1

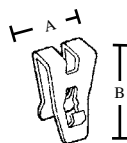

CAT#	A	B
GC99	.24	.65

## GREEN GROUND CLIP

TOPAZ		STEEL		
CAT #	UPC#	SIZE	UNIT	SHIP
			CTN	CASE
GC99	20770	#14 & #12	100	1000 3

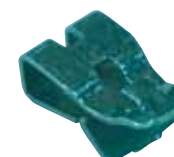

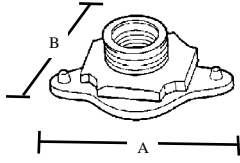

CAT#	A	B
277	1.752	.654

## NO BOLT FIXTURE STUD

ZINC DIE CAST

TOPAZ CAT #	UPC#	SIZE	UNIT CTN	SHIP CASE	WT/ CASE
277	17730	1/8" F X 3/8" M	—	100	3

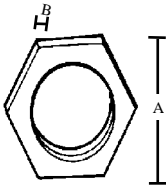

CAT#	A	B
278	.625	.20
279	.715	.20
280	1.00	.22

## FIXTURE LOCKNUTS

STEEL

TOPAZ CAT #	UPC#	SIZE	UNIT CTN	SHIP CASE	WT/ CASE
278	11710	1/8"	100	1000	1
279	11720	1/4"	100	1000	1
280	12290	3/8" SQUARE - HEAVY	—	200	5

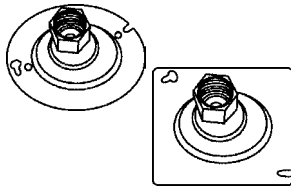

CAT#	
33R	FITS 4" OCTAGON
34S	FITS 4" SQUARE

## FLEXIBLE FIXTURE HANGERS

20° SWING FROM VERTICAL

- SUPPORTS WEIGHT 50 LBS.
- BALL TYPE SWIVEL

STEEL

TOPAZ CAT #	UPC#	SIZE	UNIT CTN	SHIP CASE	WT/ CASE
33R	10071	1/2" OR 3/4" ROUND	—	25	15
34S	10072	1/2" OR 3/4" SQUARE	—	25	18

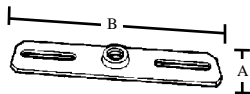

CAT#	A	B
46	1.00	4.12

## FIXTURE HANGER

- WITH GREEN GROUND SCREW
- CROSS BAR FITS ALL STANDARD SWITCH BOXES & 3-1/4" & 4" OUTLET BOXES

STEEL

TOPAZ CAT #	UPC#	SIZE	UNIT CTN	SHIP CASE	WT/ CASE
46	14170	1/8" FEMALE	—	100	4

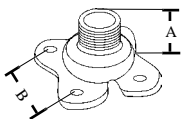

CAT#	A	B
47	1.00	1.10

MALLEABLE IRON					
TOPAZ CAT #	UPC#	SIZE	UNIT CTN	SHIP CASE	WT/ CASE
47	14171	CROWS FOOT	25	250	8



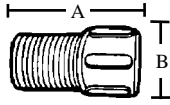

CAT#	A	B
190	1.000	.776
200	1.375	.780

## FIXTURE EXTENSIONS

ZINC DIE CAST

TOPAZ CAT #	UPC#	SIZE	UNIT CTN	SHIP CASE	WT/ CASE
190	11510	3/8" M X 1" F	100	1000	50
200	11520	3/8" M X 1 3/8" F	100	1000	60

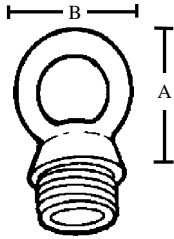

CAT#	A	B
71	1.27	1.12

## FIXTURE LOOP

ZINC DIE CAST

TOPAZ CAT #	UPC#	SIZE	UNIT CTN	SHIP CASE	WT/ CASE
71	17440	1/2" MALE	25	250	15

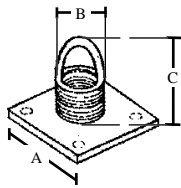

CAT#	A	B	C
71A	1.39	.57 (Opening)	1.12

## STUD LOOP & HANGER

ZINC DIE CAST

TOPAZ CAT #	UPC#	SIZE	UNIT CTN	SHIP CASE	WT/ CASE
71A	17442	1/2"	-	100	7



## LAMP HOLDER

PLASTIC

TOPAZ CAT #	UPC#	SIZE	UNIT CTN	SHIP CASE	WT/ CASE
P2	84005	Medium Base	1	50	25

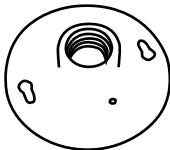

## LAMP HOLDER

PORCELAIN

TOPAZ CAT #	UPC#	SIZE	UNIT CTN	SHIP CASE	WT/ CASE
POR1	84006	Medium Base	24	100	10



## AC DISCONNECT

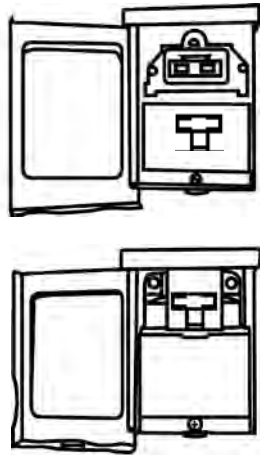

CAT#	CABINET SIZE		
	H	W	D
ACD48	6 1/24	4 7/8	2 3/4
ACD49	6 1/2	4 7/8	2 3/4
ACD50	9	4 7/8	2 3/4
ACD51	9	4 7/8	2 3/4
ACD52	10 1/2	6 1/2	3 3/8
ACD53	10 1/2	6 1/2	3 3/8

TOPAZ CAT #	UPC#	SIZE	VOLTAGE	SHIP CASE	WT/ CASE
ACD48	33781	60 AMP SWITCHABLE	120/240	6	20
ACD49	33773	60 AMP NON-FUSED PULLOUT	120/240	6	20
ACD50	33774	30 AMP FUSED	120/240	6	20
ACD51	33775	60 AMP FUSED	120/240	6	20
ACD52	33776	60 AMP NON-FUSED PULLOUT W/15 AMP GFCI RECP	120/240	6	30
ACD53	33777	60 AMP SWITCHABLE W/15 AMP GFCI RECP	120/240	6	30



WIRE RANGE DATA: CONNECTORS	COPPER		LUG TIGHTENING TORQUE (lb-in)	SCREW TYPE	WIRE SIZE	TORQUE
	SOL	STR.				
LINE	14-10	14-3	SLOTTED		8	36-40
LOAD	14-10	14-3			6-4	41-35
EQUIP.GRD.	12-10	12-4			3-2	45-50



## AC WHIPS



CAT#	LENGTH	WIRE REDUCING	
		SIZE	WASHER
ACW10	4	#10	1/2 X 3/4
ACW11	6	#10	1/2 X 3/4
ACW12	4	#8	3/4 X 1
ACW13	6	#8	3/4 X 1

TOPAZ CAT #	UPC#	CONNECTORS	CONDUIT SIZE	UNIT CTN	SHIP CASE	WT/ CASE
ACW10	33782	1/2" ST. 1/2" 90°	1/2"	—	12PK	400
ACW11	33783	1/2" ST. 1/2" 90°	1/2"	—	12PK	400
ACW12	33778	3/4" ST. 3/4" 90°	3/4"	—	12PK	400
ACW13	33779	3/4" ST. 3/4" 90°	3/4"	—	12PK	400



WITH ST. & 90° NM CONNECTORS

## MAGNETIC CIRCUIT BREAKER LABELS CBL

TOPAZ CAT #	UPC#	PREPRINTED	BLANK	UNIT CTN	SHIP CASE	WT/ CASE
CBL	19949	42	6	—	24	1

HANGS ON A POINT OF PURCHASE DISPLAY. 12 PER DISPLAY.





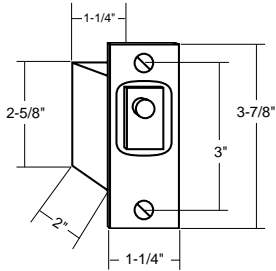

## DOOR LIGHT SWITCH

TOPAZ CAT #	UPC#	DESCRIPTION	UNIT CTN	SHIP CASE	WT/ CASE
SD1	84007	DOOR SWITCH	1	100	50



## TUBEGUARDS

• WITH END CAPS

TOPAZ CAT #	UPC#	DESCRIPTION	UNIT CTN	SHIP CASE	WT/ CASE
TGF40T12	83651	4' T12	24	24	6
TGF96T12	83652	8' T12	24	24	12
TGFP28T5	85145	4' T5 CLEAR	125	125	18
TGF032T8	83653	4' T8	24	24	10
TGF096T8	83654	8' T8	24	24	12
TGENDCAPS12	83655	T12 BLACK	48	48	35
TGENDCAPS5	85146	T5 BLACK	50	50	1
TGENDCAPS8	83656	T8 BLACK	48	48	35

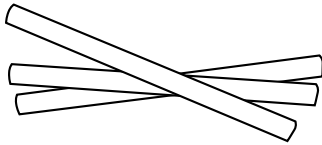

Colors Available: Amber, Blue, Pink, Green, Red. End caps are made of high heat polypropylene and are included in each carton of tubes.