

Capped Conduit Elbows

90° Female/Female Short Conduit Elbow

Type LBY

Use:

Provides a 90° change in direction in hazardous and ordinary locations where accessibility is needed for pulling conductors.

Features:

- Screw-on Cover for ease of installation and removal.
- Cover opens on an angle permitting conductors to be pulled straight through either hub.
- Can make 90° turns in conduit where a compact turn is desired.
- Female tapered threaded hubs (NPT) for rigid conduit and IMC.

Material/Finish:

½ thru 1¼: malleable iron/triple coat (1. zinc electroplate, 2. chromate, 3. powder coat epoxy)

1½: malleable iron

Third Party Certification:



UL Listed: 34997/E10444

Class I, Div. 1, 2, Groups B, C, D

Class I, Zone 1, 2, Groups IIA, IIB + H₂

Class II, Div. 1, 2, Groups E, F, G

Class III



CSA Certified: 009795/065181

Applicable Third Party Standards:

UL Standards: 514B and 886 (1203)

CSA Standard: C22.2 No. 30

Suggested Specifications:

Where 90° female/female capped conduit elbows are required, they shall be of malleable iron construction suitable for hazardous locations as defined in NEC Articles 500 through 503 and 505. The capped elbows shall be O-Z/Gedney Type LBY series.

Trade Size (inches)	Catalog Number	Dimensions in Inches	
		A	B
½	LBY-50	2¾	2⅛
¾	LBY-75	2⅞	2⅛
1	LBY-100	3⅜	2⅞
1¼	LBY-125	4	3⅞
1½	LBY-150	3⅞	3⅞

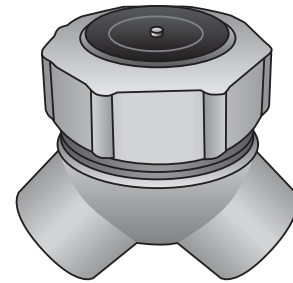
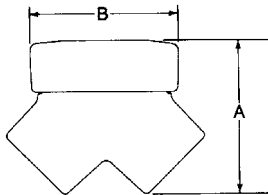

Type LBY