

Thin Wall Conduit Fittings (for EMT Conduit)

Set Screw Type Fittings – Zinc Die Cast

EMT Fittings

SET SCREW TYPE FITTINGS – ZINC DIE CAST

Features:

- Tri-head set screw may be installed using a slotted, Phillips or Robertson head screwdriver
- Concrete tight when taped
- Threadless

Standard Material:

- Zinc

Standard Finish:

- Natural

Straight Connectors – Insulated

UL File No. E-22132



Cat. #	Size	Unit Qty.	Wt. Lbs. Per 100
1450DC	1/2"	50	5
1451DC	3/4"	25	8
1452DC	1"	25	11
1453DC*	1 1/4"	10	20
1454DC*	1 1/2"	10	25
1455DC*	2"	5	37
1456DC*†	2 1/2"	12	59
1457DC*†	3"	12	78
1458DC*†	3 1/2"	6	101
1459DC*†	4"	6	120

*Two tightening screws.
†UL and cUL Listed for EMT, IMC and rigid conduit.

Straight Connectors – Non-insulated

UL File No. E-22132



Cat. #	Size	Unit Qty.	Wt. Lbs. Per 100
450DC	1/2"	50	5
451DC	3/4"	25	7
452DC	1"	25	11
453DC*	1 1/4"	10	21
454DC*	1 1/2"	10	25
455DC*	2"	5	36
456DC*†	2 1/2"	12	58
457DC*†	3"	12	77
458DC*†	3 1/2"	6	98
459DC*†	4"	6	117

*Two tightening screws.
†UL and cUL Listed for EMT, IMC and rigid conduit.

Couplings

UL File No. E-22132

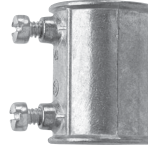

Cat. #	Size	Unit Qty.	Wt. Lbs. Per 100
460DC	1/2"	50	5
461DC	3/4"	25	7
462DC	1"	20	13
463DC*	1 1/4"	10	18
464DC*	1 1/2"	10	28
465DC*	2"	5	36
466DC*†	2 1/2"	12	64
467DC*†	3"	12	81
468DC*†	3 1/2"	6	98
469DC*†	4"	6	116

*Four tightening screws.
†UL and cUL Listed for EMT, IMC and rigid conduit.

Offset Connectors – Non-insulated

UL File No. E-22132

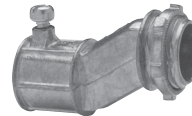

Cat. #	Size	Unit Qty.	Wt. Lbs. Per 100
2400	1/2"	10	11
2401	3/4"	10	18
2402	1"	10	25